



PLUG-IN → PROMOTION

Fiji LDFI-15

JBG2



### Cross sections:

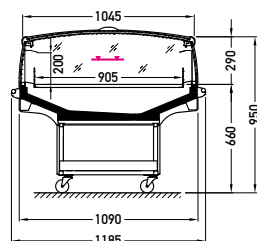

LDFI-15 CCS

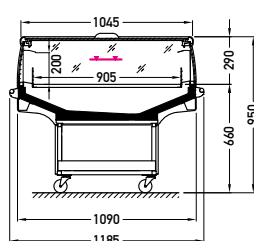

LDFI-15 CSS

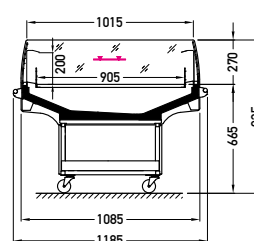

LDFI-15 BCA

**BCA** – low glass or front glass riser | single, bent | fixed

**CCS** – cover | single, curved | sliding (sideways)

**CSS** – cover | single, straight | sliding (sideways)

### Modules:

<b>BCA</b>	1000	1170	1250	1600
<b>CCS CSS</b>	1250	1600		

### Refrigerant:

R290

### Standard features:

- working temperature: from 0°C to 2°C
- electrical defrosting
- automatic evaporation of condensate
- electronic controller with temperature indicator
- **energy saving fans**
- exposition: zinc-plated steel, powder coated in white (RAL 9003)
- inox bumper  $\varnothing$ 25
- colour of the base black (RAL 9005)
- sidewalls glass with black/grey silk screen painting
- on wheels