



PLUG-IN → PROMOTION

Fiji LDFI-25

JBG2



### Cross sections:

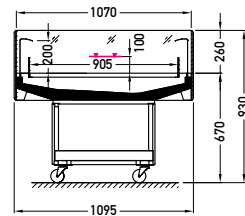

LDFI-25 BSA

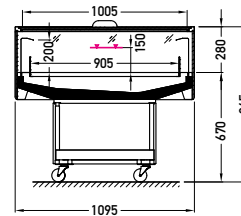

LDFI-25 CSS

**BSA** – low glass or front glass riser | single, straight | fixed  
**CSS** – cover | single, straight | sliding (sideways)



### Modules:

1250



### Refrigerant:

R290



### Standard features:

- working temperature: from 0°C to 2°C
- hot gas defrosting
- automatic evaporation of condensate
- electronic controller with temperature indicator
- **energy saving fans**
- exposition: zinc-plated steel, powder coated in white (RAL 9003)
- inox bumper  $\varnothing 25$
- colour of the base black (RAL 9005)
- sidewalls glass
- on wheels